

# Teori arsitektur – Lecture week 6: Denah Vs Potongan

Eka Permanasari

Rahma Purisari

## REM KOOLHAAS: STRATEGIC OF THE VOID

- Rem Koolhaas uses diagrams and transforms them to become an iconic form.
- First, the diagram must be used as an icon,
- Second, one must apply the iconic diagram directly to the problem of generating form.

# CRITIQUE TOWARDS THESE

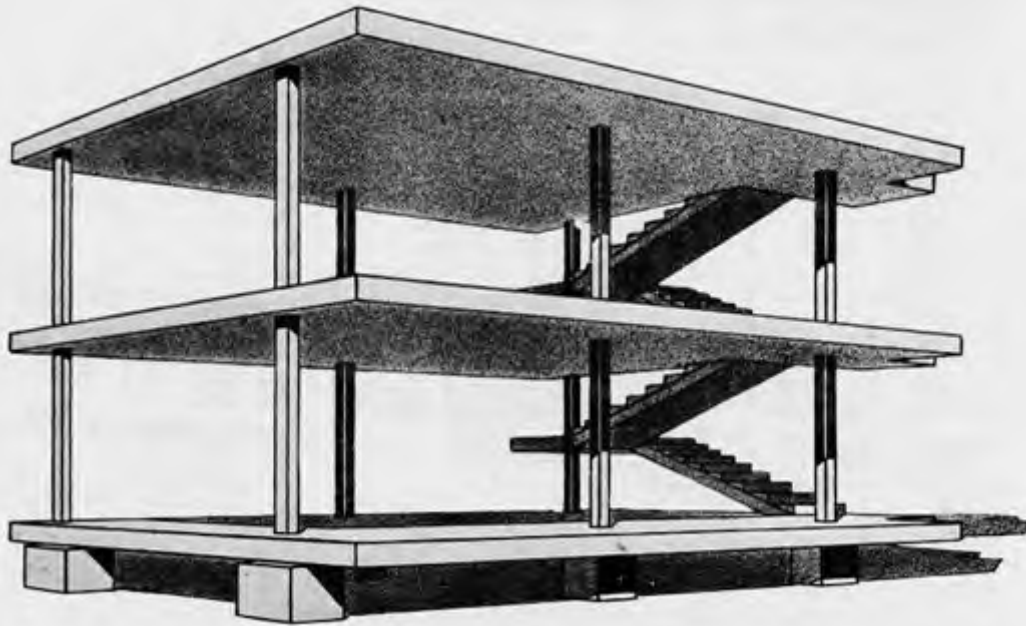

Le Corbusier, Maison Dom-ino

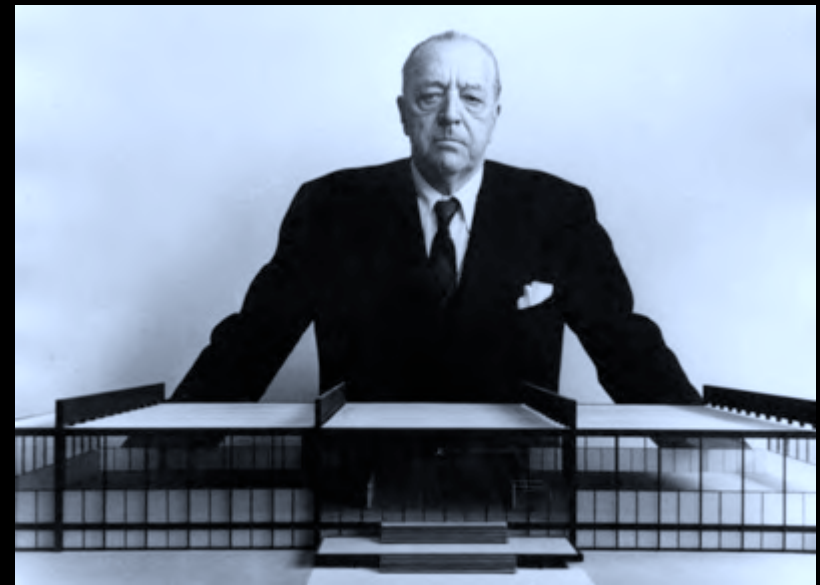

Mies Van der Rohe, Crown Hall

# ARCHITECTURE “AS A SERIES OF INCIDENTS”

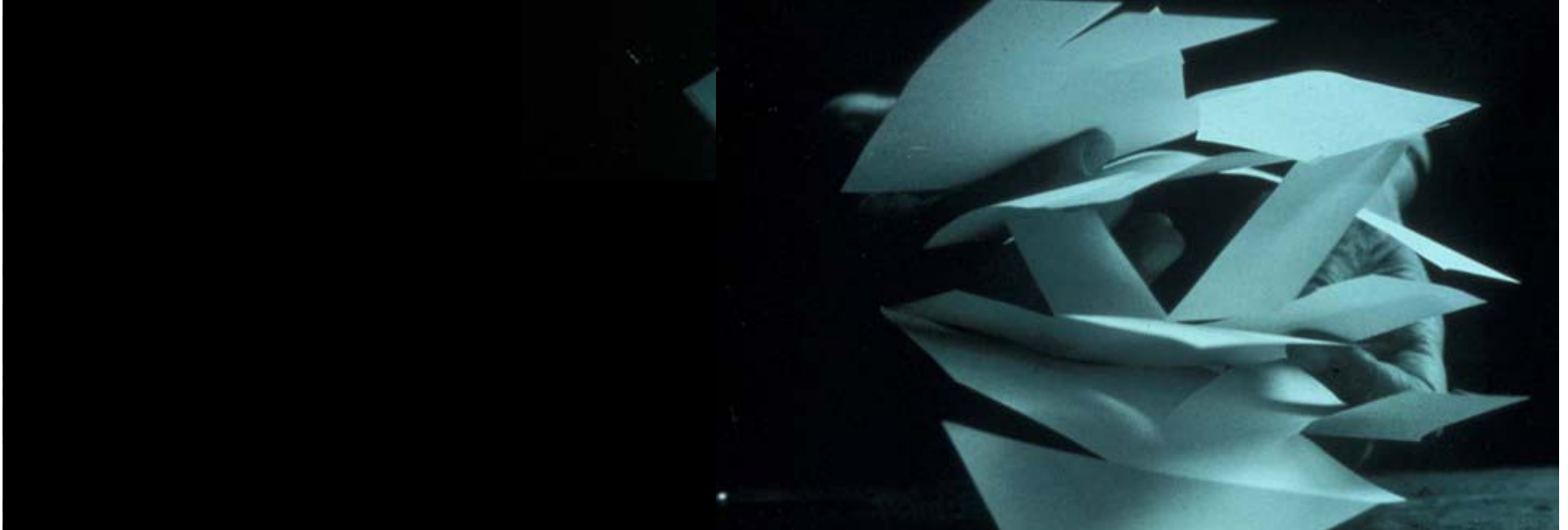
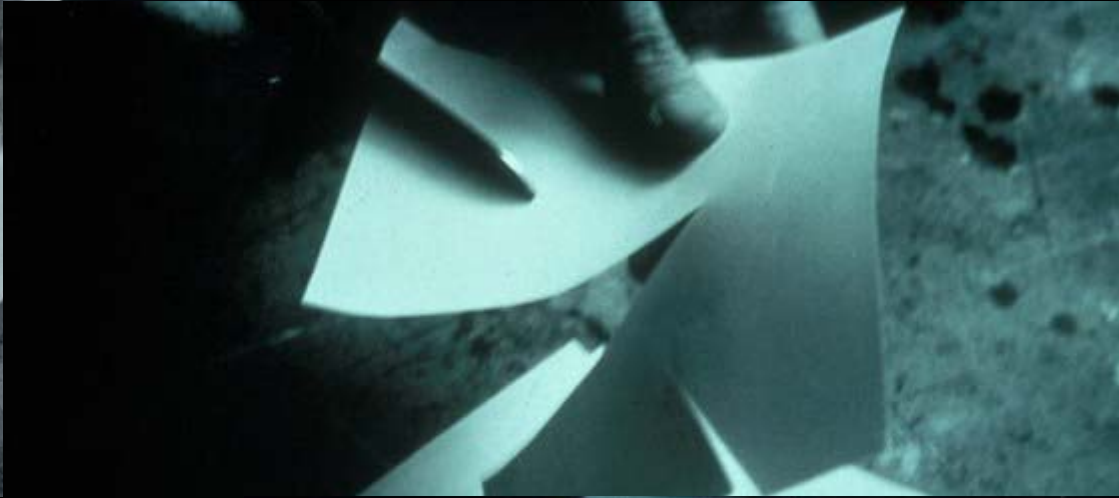

# ARCHITECTURE “AS A SERIES OF INCIDENTS”

